

GALVANIZED AND POWDER COATED STRUCTURE / STRUTTURA ZINCATA E VERNICIATA

ø 410 mm
drum/tamburo

optional page 88-93

INLET HOSE

ACS15

ASG15R

VCAR

VGSA20

P38AV



no Atex



II 2G/D
optional

ordering the "ATEX" version indicating the hose reel code preceded by "EX"
ordinare la versione "ATEX" indicando il codice dell'avvolgitubo preceduto da "EX"

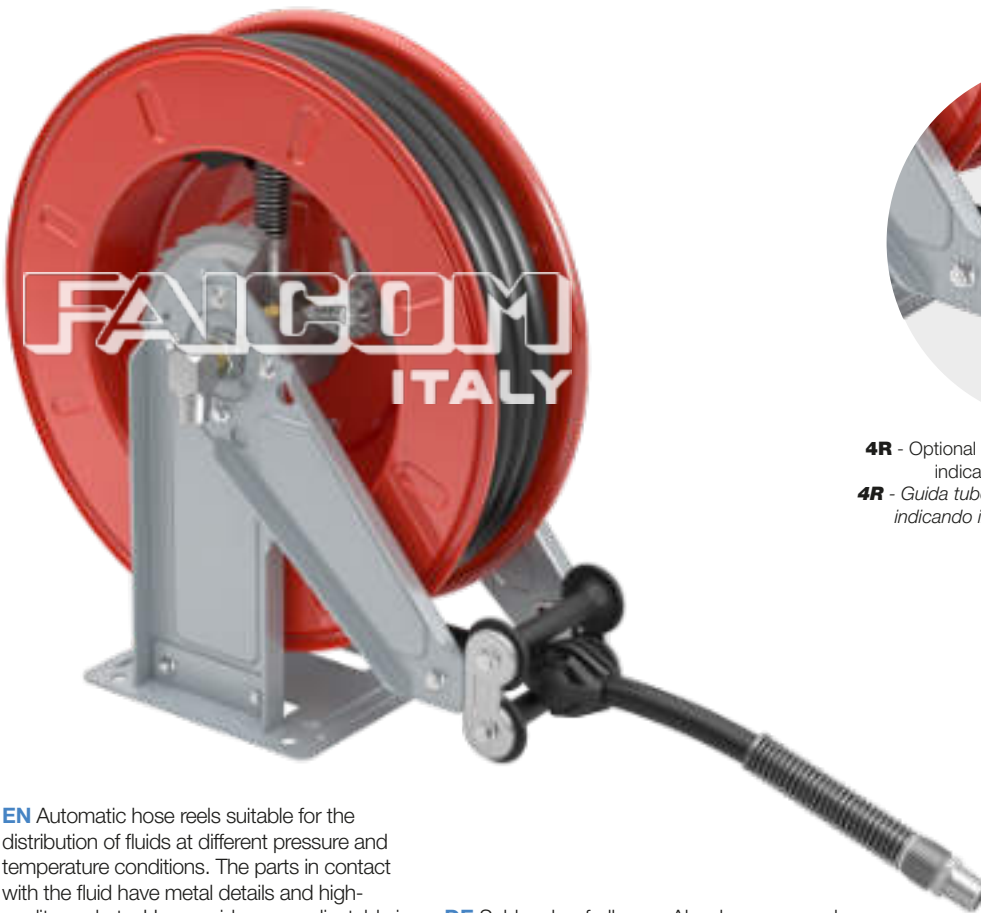

4R - Optional 4-roller hose guide. Ordering the version indicating the hose reel code followed by "4R"
4R - Guida tubo a 4 rulli opzionale. Ordinare la versione indicando il codice dell'avvolgitubo seguito da "4R"

EN Automatic hose reels suitable for the distribution of fluids at different pressure and temperature conditions. The parts in contact with the fluid have metal details and high-quality gaskets. Hose-guide arms adjustable in three different positions according to the hose reel installation (pos. A-B-C). Optional: connection hose, lateral protective covers (not available for mod. Atex), revolving stand, 4-roller hose guide, fixing bracket.

FR Enrouleurs automatiques adaptés pour distribuer des fluides à différentes pressions et températures. Composants en contact avec le fluide constitués de pièces métalliques et de joints de haute qualité. Bras guide-tuyau orientables en 3 positions différentes pour permettre l'installation souhaitée (pos. A-B-C). En option: tuyau de connexion, couvercles latéraux de protection (pas disponibles pour mod. Atex), support pivotant, guide tuyau 4 rouleaux, contre-étrier de fixation.

DE Schlauchaufroller zur Abgabe von versch. Flüssigkeiten untersch. Betriebstemperaturen und -drücke. Teile mit Kontakt von Flüssigkeiten aus spez. Metallen und Dichtungen hoher Qualität. Schwenkbare Arme für 3 versch. Positionen (s.Abb. A-B-C). Optional: Verbindungsschlauch, seitliche Schutzverkleidungen (nicht verfügbar für mod. Atex), Schwenkkonsole, Schlauchführung mit 4 Rollen und Wandbefestigung.

ES Enrolladores automáticos ideados para distribuir fluidos con diversas condiciones de presión y temperatura. Componentes en contacto con el fluido constituidos por partes metálicas y guarniciones de alta calidad. Brazos guía manguera fijables en tres diversas posiciones para permitir la instalación

deseada (pos. A-B-C). Opcional: manguera de conexión, tapas laterales de protección (no disponibles para mod. Atex), soporte giratorio, guía manguera de 4 rodillos, sujeción para fijación.

IT Avvolgitubo automatici adatti per distribuire fluidi a diverse pressioni e temperature. Parti a contatto con il fluido costituite da particolari metallici e guarnizioni di elevata qualità. Bracci guidatubo orientabili in tre diverse posizioni per consentire l'installazione desiderata (pos. A-B-C). Optional: tubo di collegamento, carter laterali di protezione (non disponibili per mod. Atex), supporto girevole, guidatubo a 4 rulli, controstaffa di fissaggio.

Dimensions (mm) / Dimensioni (mm)

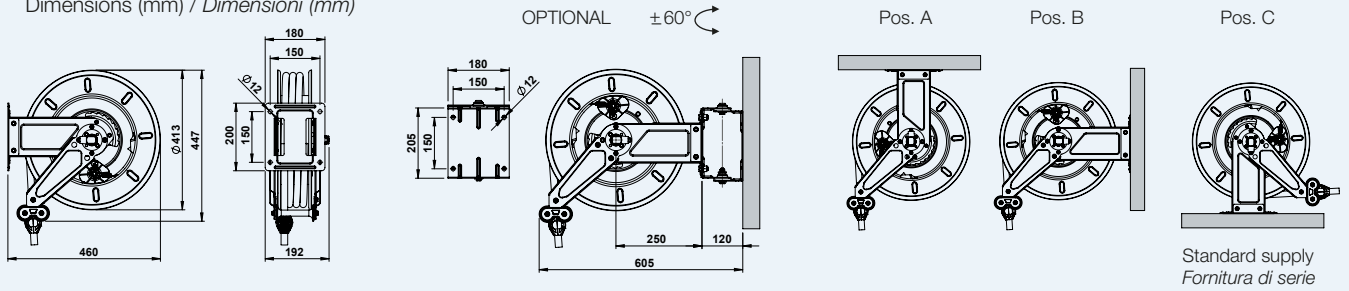

Hose reels model V without hose / Avvolgitubo modello V senza tubo

Fluid Fluido	Max. pressure Pressione max.	Code Codice	Inlet (Bsp) Entrata (Gas)	Outlet (Bsp) Uscita (Gas)	Capacity Capacità	Weight (kg) Peso (kg)	ATEX (optional)
Air/Aria - Oil/Olio Water/Acqua	60 bar/870 psi	V603815ST	3/8" F	3/8" M	15 m/50 ft	14,5	•
		V601215ST	1/2" M	1/2" M	15 m/50 ft	14,5	•
Air/Aria Water/Acqua	18 bar/260 psi	V183820ST	3/8" F	3/8" M	(ext. Ø17) 20 m/65ft	14,5	•
Air/Aria	18 bar/260 psi	V183825ST	3/8" F	3/8" M	(ext. Ø14) 25 m/80ft	14,5	•
Grease/Grasso	400 bar/5800 psi	V4G1415ST	1/4" F	1/4" M	15 m/50 ft	14,5	•
Water/Acqua 150°C	400 bar/5800 psi	V4H3815ST	3/8" F	3/8" M	15 m/50 ft	14,5	•
		*V4H3815STMX	3/8" F	3/8" M	15 m/50 ft	14,5	•

* With stainless steel swivel and shaft / Con giunto e mozzo in acciaio inox

◇ Variable indicative values according to the type of hose / Valori indicativi variabili in base alla tipologia di tubo

Hose reels model V with hose / Avvolgitubo modello V completi di tubo

Fluid Fluido	Pressure - Hose Pressione - Tubo	Code Codice	Inlet (Bsp) Entrata (Gas)	Outlet (Bsp) Uscita (Gas)	Hose diam. Tubo diam.	Hose length Lungh. Tubo	Weight (kg) Peso (kg)	Inlet hose Tubo entrata	ATEX (optional)
Air/Aria Water/Acqua	18 bar/260 psi Rubber/Gomma	V180810	3/8" F	3/8" M	8 x 14	10 m/32 ft	17	TC08005	
		V180815	3/8" F	3/8" M	8 x 14	15 m/50 ft	17	TC08005	•
		V180820	3/8" F	3/8" M	8 x 14	20 m/65 ft	18	TC08005	•
		V181010	3/8" F	3/8" M	10 x 17	10 m/32 ft	17	TC10005	•
		V181015	3/8" F	3/8" M	10 x 17	15 m/50 ft	18	TC10005	•
		V181020	3/8" F	3/8" M	10 x 17	20 m/65 ft	19	TC10005	•
		V181310	1/2" M	1/2" M	13 x 20	10 m/32 ft	18	TC13005	
		V181315	1/2" M	1/2" M	13 x 20	15 m/50 ft	19	TC13005	•
	18 bar/260 psi Thermoplastic Termoplastico	V181015SG	3/8" F	3/8" M	10 x 15	15 m/50 ft	17	TC10005SG	
		V181020SG	3/8" F	3/8" M	10 x 15	20 m/65 ft	18	TC10005SG	
V181315SG		1/2" M	1/2" M	13 x 18	15 m/50 ft	18	TC13005SG		
Air/Aria	20 bar/290 psi Polyurethane poliuretano	V200820PU	3/8" F	3/8" M	8 x 12	20 m/65 ft	17	TC08005PU	
		V201020PU	3/8" F	3/8" M	10 x 14	20 m/65 ft	17	TC10005PU	
		V201025PU	3/8" F	3/8" M	10 x 14	25 m/80 ft	17	TC10005PU	
		V201315PU	1/2" F	1/2" M	13 x 18	15 m/50 ft	17	TC13005PU	
Antifreeze/Antigelo Windshield fluid/Lavavetri	18 bar/260 psi Rubber/Gomma	*V181015MXE	1/2" M	3/8" M	10 x 17	15 m/50 ft	18	TC13005MXE	
		*V181315MXE	1/2" M	1/2" M	13 x 20	15 m/50 ft	19	TC13005MXE	•
Oil/Olio	60 bar/870 psi 1SC Rubber/Gomma	V603810	3/8" F	3/8" M	3/8"	10 m/32 ft	18	TC38005	
		V603815	3/8" F	3/8" M	3/8"	15 m/50 ft	19	TC38005	•
		V601210	1/2" M	1/2" M	1/2"	10 m/32 ft	18	TC12005	
		V601215	1/2" M	1/2" M	1/2"	15 m/50 ft	20	TC12005	•
Grease/Grasso	400 bar/5800 psi 2SN Rubber/Gomma	V4G1410	1/4" F	1/4" M	1/4"	10 m/32 ft	18	TC14005	
		V4G1415	1/4" F	1/4" M	1/4"	15 m/50 ft	20	TC14005	•
Water/Acqua 150°C	250 bar/3625 psi 1SC Hydro blue	V2H3815	3/8" F	3/8" M	3/8"	15 m/50 ft	20	TC38005H	
		V4H3810	3/8" F	3/8" M	3/8"	10 m/32 ft	19	TC38005H	
	400 bar/5800 psi 2SC Hydro blue	V4H3815	3/8" F	3/8" M	3/8"	15 m/50 ft	21	TC38005H	•
		V4H5115	3/8" F	3/8" M	5/16"	15 m/50 ft	20	TC38005H	•
Waste oil/Olio esausto 100°C	Suction/Aspirazione 1SC Rubber/Gomma	V601207A	1/2" M	1/2" F	1/2"	7 m/22 ft	18	TC12005	

* With stainless steel swivel and shaft / Con giunto e mozzo in acciaio inox